

EN User manual

2

Washing Machine

# USER MANUAL

ZWS 568  
ZWS 588

**ZANUSSI**  
Get Living!

# Contents

Safety information	2	What to do if...	13
Product description	4	Technical data	16
Control panel	5	Consumption values	16
First use	6	Care and cleaning	17
Daily use	6	Installation	19
Helpful hints and tips	8	Electrical connection	21
Washing programmes	9	Environment concerns	21

Subject to change without notice



## Safety information

**Important!** Read carefully & keep for future reference.

- The safety of Your appliance complies with the industry standards and with legal requirements on the safety of appliances. However, as manufacturers, we feel it is our duty to provide the following safety notes.
- It is most important that this instruction book should be retained with the appliance for future reference. Should the appliance be sold or transferred to another owner, or should you move house and leave the appliance, always ensure that the book is supplied with the appliance in order that the new owner can get to know the functioning of the appliance and the relevant warnings.
- You **MUST** read them carefully before installing or using the appliance.
- Before first starting up, check the appliance for any damage incurred during transport. Never connect up a damaged appliance. If parts are damaged, contact your supplier.
- If the appliance is delivered in the winter months when there are minus temperatures. Store it at room temperature for 24 hours before using for the first time.

### General safety

- It is dangerous to alter the specifications or attempt to modify this product in any way.
- During high temperature wash programmes the door glass may get hot. Do not touch it!
- Make sure that small pets do not climb into the drum. To avoid this, please check into the drum before using.
- Any objects such as coins, safety pins, nails, screws, stones or any other hard, sharp material can cause extensive damage and must not be placed into the machine.

- Only use the advised quantities of fabric softener and detergent. Damage to the fabric can ensue if you over-fill. Refer to the manufacturer's recommendations of quantities.
- Wash small items such as socks, laces, washable belts etc in a washing bag or pillow case as it is possible for such items to slip down between the tub and the inner drum.
- Do not use your washing machine to wash articles with whalebones, material without hems or torn material.
- Always unplug the appliance and turn off the water supply after use, cleaning and maintenance.
- Under no circumstances should you attempt to repair the machine yourself. Repairs carried out by inexperienced people may cause injury or serious malfunctioning. Contact your local Service Centre. Always insist on genuine spare parts.

### Installation

- This appliance is heavy. Care should be taken when moving it.
- When unpacking the appliance, check that it is not damaged. If in doubt, do not use it and contact the Service Centre.
- All packing and transit bolts must be removed before use. Serious damage can occur to the product and to property if this is not adhered to. See relevant section in the user manual.
- After having installed the appliance, check that it is not standing on the inlet and drain hose and the worktop is not pressing the electrical supply cable against the wall.
- If the machine is situated on a carpeted floor, please adjust the feet in order to allow air to circulate freely under the appliance.

- Always be sure, that there is no water leakage from hoses and their connections after the installation.
- If the appliance is installed in a location subject to frost, please read the “dangers of freezing” chapter.
- Any plumbing work required to install this appliance should be carried out by a qualified plumber or competent person.
- Any electrical work required to install this appliance should be carried out by a qualified electrician or competent person.

## Use

- This appliance is designed for domestic use. It must not be used for purposes other than those for which it was designed.
- Only wash fabrics which are designed to be machine washed. Follow the instructions on each garment label.
- Do not overload the appliance. See the Washing Programme Table.
- Before washing, ensure that all pockets are empty and buttons and zips are fastened. Avoid washing frayed or torn articles and treat stains such as paint, ink, rust, and grass before washing. Underwired bras must NOT be machine washed.
- Garments which have been in contact with volatile petroleum products should not be machine washed. If volatile cleaning fluids are used, care should be taken to ensure that the fluid is removed from the garment before placing in the machine.
- Never pull the power supply cable to remove the plug from the socket; always take hold of the plug itself.
- Never use the appliance if the power supply cable, the control panel, the working surface or the base are damaged so that the inside of the washing machine is accessible.

## Child safety

- This appliance is not intended for use by person (including children) with reduced physical sensory or mental capabilities or lack of experience and knowledge unless they have been given supervision or instruction concerning use of the appliance by a person responsible for their safety.
- The packaging components (e.g. plastic film, polystyrene) can be dangerous to children - danger of suffocation! Keep them out of children's reach
- Keep all detergents in a safe place out of children's reach.
- Make sure that children or pets do not climb into the drum. To prevent children and pets becoming trapped inside the drum this machine incorporates a special feature.

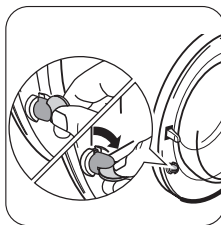

To **activate** this device, rotate the button (without pressing it) inside the door clockwise until the groove is horizontal. If necessary use a coin.

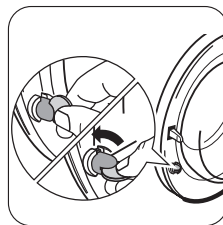

To **disable** this device and restore the possibility of closing the door, rotate the button anti-clockwise until the groove is vertical.

## Product description

---

- 1 Detergent dispenser drawer
- 2 Control panel
- 3 Door opening handle
- 4 Rating plate
- 5 Drain pump
- 6 Adjustable feet

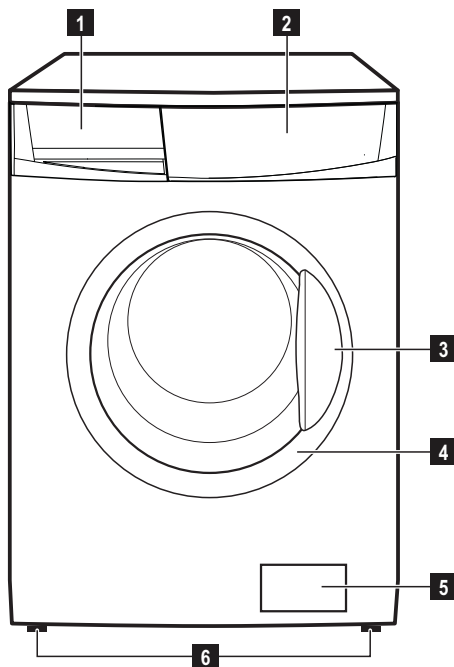

### Detergent dispenser drawer

 Compartment for detergent used for prewash and soak phase or for stain remover used during the stain action phase (if available). The prewash and soak detergent is added at the beginning of the wash programme. The stain remover is added during the stain action phase.

 Compartment for powder or liquid detergent used for main wash. If using liquid detergent pour it **just before** starting the programme.

 Compartment for liquid additives (fabric softener, starch).

Follow the product manufacturer's recommendations on quantities to use and do not exceed the «MAX» mark in the detergent dispenser drawer. Any fabric softener or starching additives must be poured into the compartment before starting the wash programme.

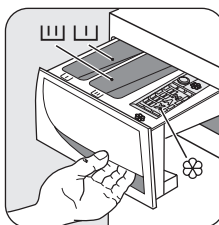

## Control panel

**i** Below is a picture of the control panel. It shows the programme selector dial as well as the buttons, pilot lights and the display. These are presented by relevant numbers on the following pages.

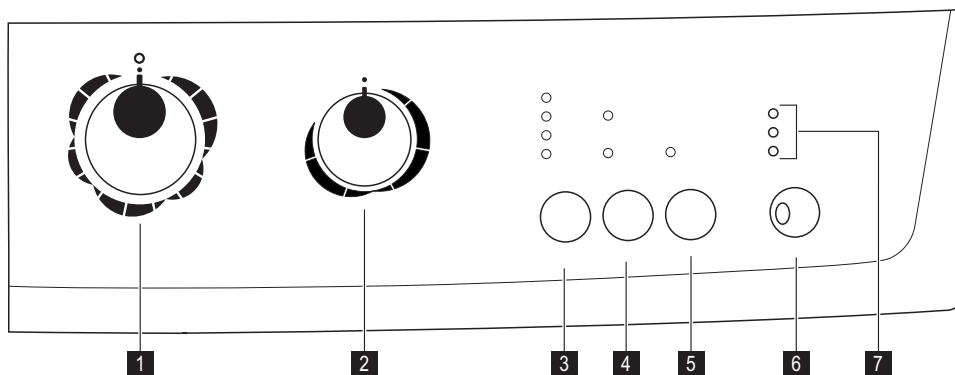

- 1** Programme selector dial
- 2** Temperature selector dial
- 3** SPIN reduction button
- 4** OPTIONS button

- 5** EXTRA RINSE button
- 6** START/PAUSE button
- 7** Indicator Pilot Light

## Table of symbols

 Cold water

 Rinse Hold

## Programme and temperature selector dials, spin speed button and available options

### Programme Selector Dial

It allows you to switch the appliance on/off and/or to select a programme.

### Temperature selector dial

This dial allows you to select the temperature more suitable to the laundry to be washed.

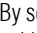
By selecting the position  the machine will wash with cold water.

### Available options:

#### Spin Reduction

By pressing this button you can change the spin speed of the selected programme.

### Rinse hold

By selecting this function the water of the last rinse is not emptied out to prevent the fabrics from creasing. Before opening the door it will be necessary to empty out the water. To empty out the water, please read the paragraph «At the end of the programme».

### Easy Iron

By selecting this option the laundry is gently washed and spun to avoid any creasing. In this way ironing is easier. Furthermore the machine will perform some additional rinses in some programmes. On cotton programmes the maximum spin speed is reduced automatically.

## Super Quick

Short cycle for lightly soiled items or for laundry which needs only freshening up. We recommend you to reduce the fabrics loading.



## Extra Rinse

This appliance is designed to save energy. If it necessary to rinse the laundry using an extra quantity of water (extra rinse), select this option. Some additional rinses will be performed. This option is recommended for people who are allergic to detergents, and in areas where the water is very soft.

## Start/Pause

This button allows you to start or to interrupt the selected programme.

## First use

-  • Ensure that the electrical and water connections comply with the installation instructions.
- Remove the polystyrene block and any material from the drum.
- Pour 2 liters of water into the main wash compartment  of the detergent drawer in order to activate the

## Daily use

### Load the laundry



Open the door by carefully pulling the door handle outwards. Place the laundry in the drum, one item at a time, shaking them out as much as possible. Close the door.

## Indicator pilot light (7)

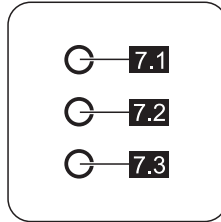

The light **7.1** illuminates after pressing button **6**. The light **7.2** is on when the machine is rinsing or spinning phase. The light **7.3** illuminates at the end of the washing cycle.

**ECO** valve. Then run a cotton cycle at the highest temperature without any laundry in the machine, to remove any manufacturing residue from the drum and tub. Pour 1/2 a measure of detergent into the main wash compartment and start the machine.

### Measure out the detergent and the fabric softener

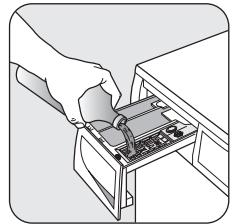
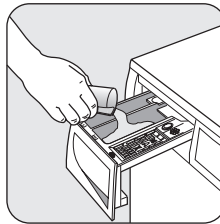

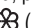
Pull out the dispenser drawer until it stops. Measure out the amount of detergent required, pour it into the main wash compartment  or in the appropriate compartment if the selected programme/option it requires (see more details in "Detergent dispenser drawer"). If required, pour fabric softener into the compartment marked  (the amount used must not exceed the «MAX» mark in the drawer). Close the drawer gently.

## Select the required programme by turning the programme selector dial (1)

Turn the programme selector dial to the required programme. The washing machine will automatically select the maximum spin value provided for the programme you have chosen. You can change this value by pressing the corresponding button. The **green** pilot light of the button **6** starts to flash.

The selector dial can be turned either clockwise or counterclockwise. Turn to position « **0** » to reset programme/ Switching the machine off.

**At the end of the programme the selector dial must be turned to position 0, to switch the machine off.**

 **Caution!** If you turn the programme selector dial to another programme when the machine is working, the **red** pilot light of button **6** will blink 3 times to indicate a wrong selection. The machine will not perform the new selected programme.

## Select the required temperature by turning the temperature selector dial (2)

Turn clockwise this dial to select the more convenient to your laundry washing temperature.

## Select the available options by pressing buttons 3, 4 and 5

Depending on the programme, different functions can be combined. These must be selected after choosing the desired programme and before starting the programme.

When these buttons are pressed, the corresponding pilot lights illuminate. When they are pressed again, the pilot lights go out. If an incorrect option is selected, the integrated **red** pilot light of the button **6** flashes for 3 times.

 For the compatibility among the washing programmes and the options see chapter «Washing Programmes».

## Start the programme by pressing button 6

To start the selected programme, press the button **6**, the corresponding green pilot light stops blinking. The appliance starts operating and the only pilot light corresponding to the running phase stays on.

To interrupt a programme which is running, press the button **6**: the corresponding green pilot light starts blinking.

To restart the programme from the point at which it was interrupted, press the button **6** again.

If an incorrect option is selected, the **red** pilot light of the button **6** blinks 3 times.

## Altering an option or a running programme

It is possible to change some options before the programme carries them out.

Before you make any change, you must **PAUSE** the appliance by pressing the button **6**.

Changing a running programme is possible only by resetting it. Turn the programme selector dial to **0** and then to the new programme position. Start the new programme by pressing the button **6** again. The washing water in the tub will be not emptied out.

## Interrupting a programme

Press the button **6** to interrupt a programme which is running, the corresponding green pilot light starts blinking.

Press the button again to **restart** the programme.

## Cancelling a programme

Turn the selector dial to  to cancel a programme which is running. Now you can select a new programme.

## Opening the door

After the programme has started the door is locked. If, for any reason, you need to open it, set firstly the machine to **PAUSE** by pressing the button **6**. After a few minutes it will be possible to open the door.

If the door remains locked, this means that the machine is already heating or that the water level is too high. In any case, do not try to force the door!

If you cannot open the door but you need to open it you have to switch the machine off by turning the selector dial to **0**. After a few minutes the door can be opened (**pay attention to the water level and temperature!**).

After closing the door, it is necessary to select the programme and options again and to press button **6**.

## At the end of the programme

The machine stops automatically. The pilot light of button **6** and the pilot light corresponding to the just finished washing phase go off. The light **7.3** illuminates.

If a programme or an option that ends with water left in the tub has been selected, the light **7.3** illuminates but the door remains locked to indicate that the water must be emptied out before opening the door.

Follow the below instructions to empty out the water:

1. Turn the programme selector dial to **0**.
2. Select the draining or spinning programme.

3. Reduce the spin speed if needed, by pressing the relevant button.
  4. Press button **6**.
- At the end of the programme, the door can be now opened. Turn the programme selector dial to **0** to switch the machine off.

## Helpful hints and tips

---

### Sorting out the laundry

Follow the wash code symbols on each garment label and the manufacturer's washing instructions. Sort the laundry as follows: whites, coloureds, synthetics, delicates, wool-lens.

### Before loading the laundry

Never wash whites and coloureds together. Whites may lose their «whiteness» in the wash. New coloured items may run in the first wash; they should therefore be washed separately the first time. Button up pillowcases, close zip fasteners, hooks and poppers. Tie any belts or long tapes. Remove persistent stains before washing. Rub particularly soiled areas with a special detergent or detergent paste. Treat curtains with special care. Remove hooks or tie them up in a bag or net.

### Removing stains

Stubborn stains may not be removed by just water and detergent. It is therefore advisable to treat them prior to washing.

**Blood:** treat fresh stains with cold water. For dried stains, soak overnight in water with a special detergent then rub in the soap and water.

**Oil based paint:** moisten with benzine stain remover, lay the garment on a soft cloth and dab the stain; treat several times.

**Dried grease stains:** moisten with turpentine, lay the garment on a soft surface and dab the stain with the fingertips and a cotton cloth.

**Rust:** oxalic acid dissolved in hot water or a rust removing product used cold. Be careful with rust stains which are not recent since the cellulose structure will already have been damaged and the fabric tends to hole.

**Mould stains:** treat with bleach, rinse well (whites and fast coloureds only).

**Grass:** soap lightly and treat with bleach (whites and fast coloureds only).

1) do not use acetone on artificial silk

Remove the laundry from the drum and carefully check that the drum is empty. If you do not intend to carry out another wash, close the water tap. Leave the door open to prevent the formation of mildew and unpleasant smells.

**Ball point pen and glue:** moisten with acetone<sup>1)</sup>, lay the garment on a soft cloth and dab the stain.

**Lipstick:** moisten with acetone as above, then treat stains with methylated spirits. Treat any residual marks with bleach.

**Red wine:** soak in water and detergent, rinse and treat with acetic or citric acid, then rinse. Treat any residual marks with bleach.

**Ink:** depending on the type of ink, moisten the fabric first with acetone<sup>1)</sup>, then with acetic acid; treat any residual marks on white fabrics with bleach and then rinse thoroughly.

**Tar stains:** first treat with stain remover, methylated spirits or benzine, then rub with detergent paste.

### Detergents and additives

Good washing results also depend on the choice of detergent and use of the correct quantities to avoid waste and protect the environment.

Although biodegradable, detergents contain substances which, in large quantities, can upset the delicate balance of nature.

The choice of detergent will depend on the type of fabric (delicates; woollens, cottons, etc.), the colour, washing temperature and degree of soiling.

All commonly available washing machine detergents may be used in this appliance:

- powder detergents for all types of fabric
- powder detergents for delicate fabrics (60°C max) and woollens
- liquid detergents, preferably for low temperature wash programmes (60°C max) for all types of fabric, or special for woollens only.

The detergent and any additives must be placed in the appropriate compartments of the dispenser drawer before starting the wash programme.

If using liquid detergents, a programme **without** prewash must be selected.



Your appliance incorporates a recirculation system which allows an optimal use of the concentrated detergent.

Follow the product manufacturer's recommendations on quantities to use and do **not exceed the «MAX» mark in the detergent dispenser drawer**.

### Quantity of detergent to be used

The type and quantity of detergent will depend on the type of fabric, load size, degree of soiling and hardness of the water used.

Follow the product manufacturers' instructions on quantities to use.

Use less detergent if:



- you are washing a small load



- the laundry is lightly soiled
- large amounts of foam form during washing.





### Degrees of water hardness



Water hardness is classified in so-called "degrees" of hardness. Information on hardness of the water in your area can be obtained from the relevant water supply company, or from your local authority. If the water hardness degree is medium or high we suggest you to add a water softener following always the manufacturer's instructions. When the degree of hardness is soft, readjust the quantity of the detergent.

## Washing programmes

Programme Maximum and Minimum Temperature Cycle Description Maximum Spin Speed Maximum Fabrics Load Type of Laundry	Options	Detergent Compartment
<b>COTTONS NORMAL</b> 90°-Cold Main wash - Rinses Maximum spin speed 600 rpm for ZWS 568 Maximum spin speed 800 rpm for ZWS 588 Max. load 6 kg - Reduced load 3 kg <sup>1)</sup> <b>White and coloured cotton</b> (normally soiled items).	SPIN, RINSE HOLD, EASY IRON <sup>2)</sup> , SUPER QUICK, EXTRA RINSE	
<b>COTTONS NORMAL + PREWASH</b> 90°-Cold Prewash - Main wash - Rinses Maximum spin speed 600 rpm for ZWS 568 Maximum spin speed 800 rpm for ZWS 588 Max. load 6 kg - Reduced load 3 kg <sup>1)</sup> <b>White and coloured cotton</b> (heavy soiled items).	SPIN, RINSE HOLD, EASY IRON <sup>2)</sup> , SUPER QUICK, EXTRA RINSE	

Programme Maximum and Minimum Temperature Cycle Description Maximum Spin Speed Maximum Fabrics Load Type of Laundry	Options	Detergent Compartment
<b>COTTONS</b> <b>ECO</b> <sup>4)</sup> 90°-40° Main wash - Rinses Maximum spin speed 600 rpm for ZWS 568 Maximum spin speed 800 rpm for ZWS 588 Max. load 6 kg <b>White and coloured cotton.</b> This programme can be selected for slightly or normally soiled cotton items. The temperature will decrease and the washing time will be extended. This allows to obtain a good washing efficiency by saving energy.	SPIN, RINSE HOLD, EASY IRON <sup>2)</sup> , EXTRA RINSE	
<b>COTTONS</b> <b>ECO + PREWASH</b> <sup>4)</sup> 90°-40° Prewash - Main wash - Rinses Maximum spin speed 600 rpm for ZWS 568 Maximum spin speed 800 rpm for ZWS 588 Max. load 6 kg <b>White and coloured cotton.</b> This programme can be selected for normally soiled cotton items. The temperature will decrease and the washing time will be extended. This allows to obtain a good washing efficiency by saving energy.	SPIN, RINSE HOLD, EASY IRON <sup>2)</sup> , EXTRA RINSE	
<b>SYNTHETICS</b> <b>NORMAL</b> 60°-Cold Main wash - Rinses Maximum spin speed 600 rpm for ZWS 568 Maximum spin speed 800 rpm for ZWS 588 Max. load 3 kg - Reduced load 1.5 kg <sup>1)</sup> <b>Synthetic or mixed fabrics:</b> underwear, coloured garments, non-shrink shirts, blouses.	SPIN, RINSE HOLD, EASY IRON <sup>2)</sup> , SUPER QUICK, EXTRA RINSE	

Programme Maximum and Minimum Temperature Cycle Description Maximum Spin Speed Maximum Fabrics Load Type of Laundry	Options	Detergent Compartment
<b>SYNTHETICS</b> <b>NORMAL + PREWASH</b> 60°-Cold Prewash - Main wash - Rinses Maximum spin speed 600 rpm for ZWS 568 Maximum spin speed 800 rpm for ZWS 588 Max. load 3 kg - Reduced load 1.5 kg <sup>1)</sup> <b>Synthetic or mixed fabrics:</b> underwear, coloured garments, non-shrink shirts, blouses.	SPIN, RINSE HOLD, EASY IRON <sup>2)</sup> , SUPER QUICK, EXTRA RINSE	
<b>DELICATES</b> 40°-Cold Main wash - Rinses Maximum spin speed 600 rpm for ZWS 568 Maximum spin speed 600 rpm for ZWS 588 Max. load kg 3 - Reduced load 1.5 kg <sup>1)</sup> <b>Delicate fabrics:</b> acrylics, viscose, polyester.	SPIN, RINSE HOLD, SUPER QUICK, EXTRA RINSE	
<b>WOOL</b> 40°-Cold Main wash - Rinses Maximum spin speed 600 rpm for ZWS 568 Maximum spin speed 800 rpm for ZWS 588 Max. load 2 kg Washing programme for machine washable wool as well as for hand washable woollens and delicate fabrics. <b>Note :</b> A single or bulky item may cause imbalance. If the appliance doesn't perform the final spin phase, add more items, redistribute the load manually and then select the spinning programme.	SPIN, RINSE HOLD	
<b>HANDWASH</b> 30°-Cold Main wash - Rinses Maximum spin speed 600 rpm for ZWS 568 Maximum spin speed 800 rpm for ZWS 588 Max. load 2 kg Special programme for delicate fabrics with «hand washing» care symbol.	SPIN, RINSE HOLD	

Programme Maximum and Minimum Temperature Cycle Description Maximum Spin Speed Maximum Fabrics Load Type of Laundry	Options	Detergent Compartment
<b>JEANS</b> 60°-Cold Main wash - Rinses Maximum spin speed 600 rpm for ZWS 568 Maximum spin speed 800 rpm for ZWS 588 Max. load 3 kg With this programme it is possible to wash items like pants, shirts or jackets in denim and also jersey realized with hi-tech materials. (The Extra Rinse option will be activated automatically).	SPIN, RINSE HOLD, EASY IRON <sup>2)</sup>	
<b>SPORT INTENSIVE</b> 40°-Cold Prewash - Main wash - Rinses Maximum spin speed 600 rpm for ZWS 568 Maximum spin speed 800 rpm for ZWS 588 Max. load 3 kg This programme is suitable for washing heavily soiled sport items. The machine will add automatically a prewash phase before the main wash to eliminate mud stains.	SPIN, RINSE HOLD, EXTRA RINSE	
<b>RINSES</b> Rinses Maximum spin speed 600 rpm for ZWS 568 Maximum spin speed 800 rpm for ZWS 588 Max. load 6 kg With this programme it is possible to rinse and spin cotton garments which have been washed by hand. The machine performs 3 rinses, followed by a final long spin. The spin speed can be reduced.	SPIN, RINSE HOLD, EASY IRON <sup>2)</sup> , EXTRA RINSE	
<b>DRAIN</b> Draining of water Max. load 6 kg For emptying out the water of the last rinse in programmes with the Rinse Hold option selected.		

Programme Maximum and Minimum Temperature Cycle Description Maximum Spin Speed Maximum Fabrics Load Type of Laundry	Options	Detergent Compartment
<b>SPIN</b> Drain and long spin Maximum spin speed 600 rpm for ZWS 568 Maximum spin speed 800 rpm for ZWS 588 Max. load 6 kg Separate spin for hand washed garments and after programmes with the Rinse Hold option selected. You can choose the spin speed by pressing the relevant button to adapt it to the fabrics to be spun.	SPIN	
<b>0 = OFF</b> For cancelling the programme which is running or to switch the machine off .		

- 1) If you select the Super Quick option by pressing button **4** , we recommend that you reduce the maximum load as indicated. Full loading is possible however with somewhat reduced cleaning results.
- 2) Max. load with Easy iron option 1 kg
- 3) If using liquid detergents, a programme without PREWASH must be selected.
- 4) This programme is not active at a temperature lower than 40°C.

## What to do if...

Certain problems are due to lack of simple maintenance or oversights, which can be solved easily without calling out an engineer. Before contacting your local Service Centre, please carry out the checks listed below.

During machine operation it is possible that the **red** pilot light of button **6** blinks to indicate that the machine is not working.

Once the problem has been eliminated, press the button **6** to restart the programme. If after all checks, the problem persists, contact your local Service Centre.

Problem	Possible cause/Solution
<b>The washing machine does not start:</b>	<p>The door has not been closed (the button <b>6</b> red light blinks).</p> <ul style="list-style-type: none"> <li>• Close the door firmly.</li> </ul> <p>The plug is not properly inserted in the power socket.</p> <ul style="list-style-type: none"> <li>• Insert the plug into the power socket.</li> </ul> <p>There is no power at the socket.</p> <ul style="list-style-type: none"> <li>• Please check your domestic electrical installation.</li> </ul> <p>The main fuse has blown.</p> <ul style="list-style-type: none"> <li>• Replace the fuse.</li> </ul> <p>The programme selector dial is not correctly positioned and the button <b>6</b> has not been pressed.</p> <ul style="list-style-type: none"> <li>• Please turn the selector dial and press the button <b>6</b> again.</li> </ul> <p>The delay start has been selected.</p> <ul style="list-style-type: none"> <li>• If the laundry are to be washed immediately, cancel the delay start.</li> </ul>
<b>The machine does not fill:</b>	<p>The water tap is closed (the button <b>6</b> red light blinks).</p> <ul style="list-style-type: none"> <li>• Open the water tap.</li> </ul> <p>The inlet hose is squashed or kinked (the button <b>6</b> red light blinks).</p> <ul style="list-style-type: none"> <li>• Check the inlet hose connection.</li> </ul> <p>The filter in the inlet hose or the inlet valve filter are blocked (the button <b>6</b> red light blinks).</p> <ul style="list-style-type: none"> <li>• Clean the water inlet filters. (See "Cleaning the water inlet filters" for more details).</li> </ul> <p>The door is not properly closed (the button <b>6</b> red light blinks).</p> <ul style="list-style-type: none"> <li>• Close the door firmly.</li> </ul>
<b>The machine does not empty and/or does not spin:</b>	<p>The drain hose is squashed or kinked (the button <b>6</b> red light blinks).</p> <ul style="list-style-type: none"> <li>• Check the drain hose connection.</li> </ul> <p>The drain filter is clogged (the button <b>6</b> red light blinks).</p> <ul style="list-style-type: none"> <li>• Clean the drain filter.</li> </ul> <p>An option or a programme that ends with the water still in the tub or a that eliminates all the spinning phases has been selected.</p> <ul style="list-style-type: none"> <li>• Select the draining or spinning programme.</li> </ul> <p>The laundry is not evenly distributed in the drum.</p> <ul style="list-style-type: none"> <li>• Redistribute the laundry.</li> </ul>

Problem	Possible cause/Solution
<b>There is water on the floor:</b>	<p>Too much detergent or unsuitable detergent (creates too much foam) has been used.</p> <ul style="list-style-type: none"> <li>• Reduce the detergent quantity or use another one.</li> </ul> <p>Check whether there are any leaks from one of the inlet hose fittings. It is not always easy to see this as the water runs down the hose; check to see if it is damp.</p> <ul style="list-style-type: none"> <li>• Check the water inlet hose connection.</li> </ul> <p>The drain or inlet hose is damaged.</p> <ul style="list-style-type: none"> <li>• Replace it with a new one.</li> </ul> <p>The emergency emptying cap has not been replaced into the filter cover or the filter has not been properly screwed in after cleaning action.</p> <ul style="list-style-type: none"> <li>• Refit the emergency emptying cap into the filter cover or screw the filter fully in.</li> </ul>
<b>Unsatisfactory washing results:</b>	<p>Too little detergent or unsuitable detergent has been used.</p> <ul style="list-style-type: none"> <li>• Increase the detergent quantity or use another one.</li> </ul> <p>Stubborn stains have not been treated prior to washing.</p> <ul style="list-style-type: none"> <li>• Use commercial products to treat the stubborn stains.</li> </ul> <p>The correct temperature was not selected.</p> <ul style="list-style-type: none"> <li>• Check if you have selected the correct temperature.</li> </ul> <p>Excessive laundry load.</p> <ul style="list-style-type: none"> <li>• Reduce the laundry load.</li> </ul>
<b>The door will not open:</b>	<p>The programme is still running.</p> <ul style="list-style-type: none"> <li>• Wait the end of washing cycle.</li> </ul> <p>The door lock has not been released.</p> <ul style="list-style-type: none"> <li>• Wait a few minutes before opening the door.</li> </ul> <p>There is water in the drum.</p> <ul style="list-style-type: none"> <li>• Select drain or spin programme to empty out the water.</li> </ul>
<b>The machine vibrates is noisy:</b>	<p>The transit bolts and packing have not been removed.</p> <ul style="list-style-type: none"> <li>• Check the correct installation of the appliance.</li> </ul> <p>The support feet have not been adjusted</p> <ul style="list-style-type: none"> <li>• Check the correct levelling of the appliance.</li> </ul> <p>The laundry is not evenly distributed in the drum.</p> <ul style="list-style-type: none"> <li>• Redistribute the laundry.</li> </ul> <p>Maybe there is very little laundry in the drum.</p> <ul style="list-style-type: none"> <li>• Load more laundry.</li> </ul>

Problem	Possible cause/Solution
Spinning starts late or the machine does not spin:	<p>The electronic unbalance detection device has cut in because the laundry is not evenly distributed in the drum. The laundry is redistributed by reverse rotation of the drum. This may happen several times before the unbalance disappears and normal spinning can resume. If, after 10 minutes, the laundry is still not evenly distributed in the drum, the machine will not spin. In this case, redistribute the load manually and select the spin programme.</p> <ul style="list-style-type: none"> <li>• Redistribute the laundry.</li> </ul> <p>The load is too small.</p> <ul style="list-style-type: none"> <li>• Add more items, redistribute the load manually and then select the spinning programme.</li> </ul>

If you are unable to identify or solve the problem, contact our service centre. Before telephoning, make a note of the model, serial number and purchase date of your machine: the Service Centre will require this information.

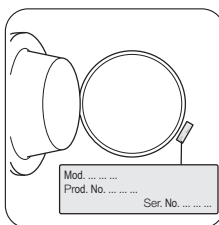

## Technical data

Dimensions	Width	60 cm
	Height	85 cm
	Depth	44 cm
Electrical connection	Information on the electrical connection is given on the rating plate, on the inner edge of the appliance door.	
Water supply pressure	Minimum	0,05 MPa
	Maximum	0,8 MPa
Maximum Load	Cotton	6 kg
Spin Speed	Maximum	600 rpm (ZWS 568) 800 rpm (ZWS 588)

## Consumption values

Programme	Energy consumption (KWh)	Water consumption (litres)	Programme duration (Minutes)
White Cottons 90°	2.1	62	140
Cottons 60°	1.3	59	130
Cotton ECO 60° <sup>1)</sup>	1.02	45	155
Cottons 40°	0.75	59	125



Programme	Energy consumption (KWh)	Water consumption (litres)	Programme duration (Minutes)
Synthetics 40°	0.5	45	80
Delicates 40°	0.55	55	70
Wool/ Handwash 30°	0.3	50	60

1) «Cottons Eco» at 60°C with a load of 6 kg is the reference programme for the data entered in the energy label, in compliance with EEC 92/75 standards.

**i** The consumption data shown on this chart is to be considered purely indicative, as it may vary depending on the quantity and type of laundry, on the inlet water temperature and on the ambient temperature.

## Care and cleaning

**!** **Warning!** You must DISCONNECT the appliance from the electricity supply, before you can carry out any cleaning or maintenance work.

### Descaling

The water we use normally contains lime. It is a good idea to periodically use a water softening powder in the machine. Do this separately from any laundry washing, and according to the softening powder manufacturer's instructions. This will help to prevent the formation of lime deposits.

### External cleaning

Clean the exterior cabinet of the appliance with soap and water only, and then dry thoroughly.

### Cleaning the dispenser drawer

The washing powder and additive dispenser drawer should be cleaned regularly.

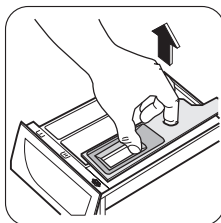

Remove the drawer by pressing the catch downwards and by pulling it out. Flush it out under a tap, to remove any traces of accumulated powder.

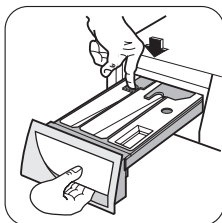

To aid cleaning, the top part of the additive compartment should be removed.

### Cleaning the drawer recess

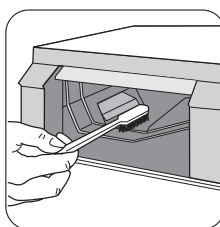

Having removed the drawer, use a small brush to clean the recess, ensuring that all washing powder residue is removed from the upper and lower part of the recess.

Replace the drawer and run the rinse programme without any clothes in the drum.

### Drain pump

The pump should be inspected regularly and particularly if:

- the machine does not empty and/or spin
- the machine makes an unusual noise during draining due to objects such as safety pins, coins etc. blocking the pump.

Proceed as follows:

- disconnect the appliance.
- if necessary wait until the water has cooled down.

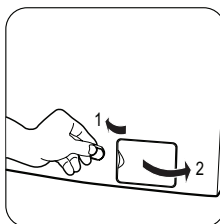

Open the pump door levering on the groove with a coin (or with the suitable tool, that you can find in the bag containing the instruction booklet, depending on the model).

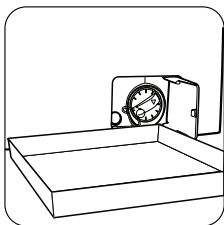

Place a bowl with a small edge close to the pump to collect any spillage.

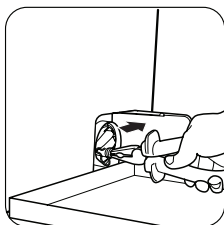

Pull out the emergency emptying cap from the filter cover, using a pliers.

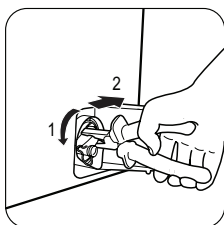

When no more water comes out, unscrew the pump cover, using a pliers, and remove the filter. Always keep a rag nearby to dry up spillage of water when removing the cover.

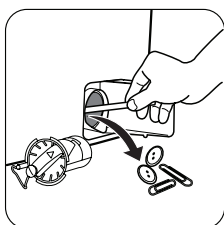

Remove any objects from the pump impeller by rotating it.

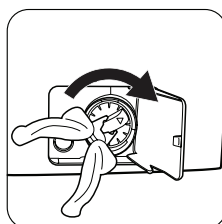
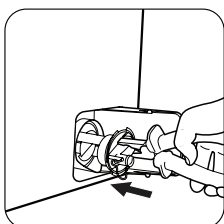

Replace the filter into the pump paying attention to insert it properly. When done, screw it firmly.

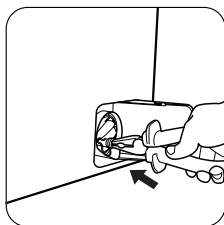

Replace the emergency emptying cap into the filter cover and fix it firmly.

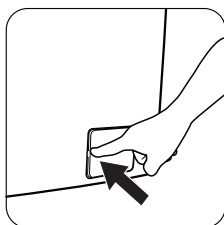

Close the pump door.

**Warning!** When the appliance is in use and depending on the programme selected there can be hot water in the pump. Never remove the pump cover during a wash cycle, always wait until the appliance has finished the cycle, and is empty. When replacing the cover, ensure it is securely re-tightened so as to stop leaks and young children being able to remove it.

### Cleaning the water inlet filters

**Important!** If the appliance doesn't fill, takes long to fill with water, the starting button blinks yellow or the display (if available) shows the relevant alarm (see chapter "What to do if..." for more details), check if the water inlet filters are blocked.

To clean the water inlet filters:

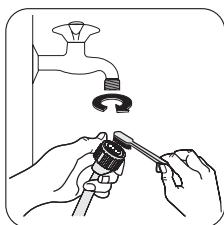

- Turn off the water tap.
- Unscrew the hose from the tap.
- Clean the filter in the hose with a stiff brush.

- Screw the hose back onto the tap. Make sure the connection is tight.

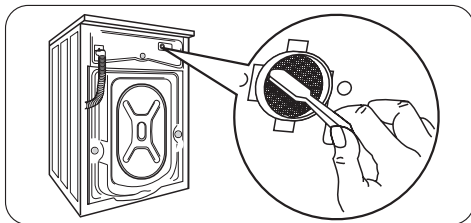

- Unscrew the hose from the machine. Keep a rag nearby because some water may flow.
- Clean the filter in the valve with a stiff brush or with the piece of cloth.

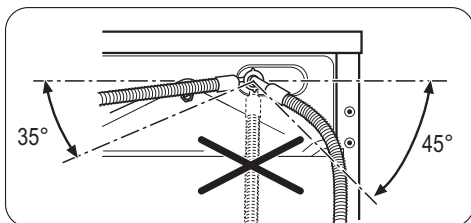

- Screw the hose back to the machine and make sure the connection is tight.
- Turn on the water tap.

### Frost precaution

If the machine is exposed to temperatures below 0°C, certain precautions should be taken.

- Turn off the water tap.
- Unscrew the inlet hose.

## Installation

### Unpacking

All transit bolts and packing must be removed before using the appliance.

You are advised to keep all transit devices so that they can be refitted if the machine ever has to be transported again.

- Place the end of the inlet hose in a bowl placed on the floor, open the emergency emptying cap of the filter and let water drain out.
- Refit the emergency emptying cap into the filter and screw the water inlet hose back.
- When you intend to start the machine up again, make sure that the room temperature is above 0°C.

### Emergency emptying out

If the water is not discharged, proceed as follows to empty out the machine:

- pull out the plug from the power socket;
- close the water tap;
- if necessary, wait until the water has cooled down;
- open the pump door;
- place a bowl on the floor. Remove the emergency emptying cap from the filter. The water should drain by gravity into the bowl. When the bowl is full, refit the emergency emptying cap into the filter. Empty the bowl. Repeat the procedure until water stops flowing out;
- clean the pump if necessary as previously described;
- screw the pump cover again and close the door.

**Important!** Every time you drain the water through the emergency emptying hose you must pour 2 litres of water into the main wash compartment of the detergent drawer and then run the drain programme. This will activate the **ECO Valve** device avoiding that part of the detergent remains unused at next washing.



After removing all the packaging, carefully lay machine on it's back to remove the polystyrene base from the bottom.

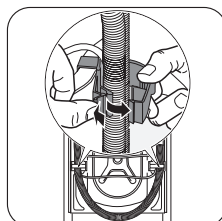

Remove the power supply cable and the hoses from the hose holders on the rear of the appliance.

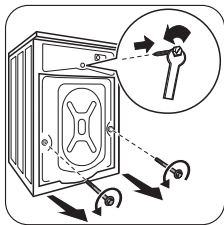

Unscrew the three bolts.

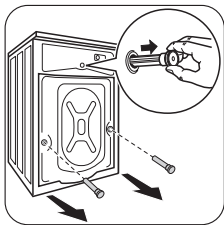

Slide out the relevant plastic spacers.

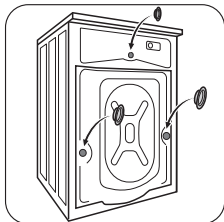

Fill the smaller upper hole and the two large ones with the corresponding plastic plug caps supplied in the bag containing the instruction booklet.

## Positioning

Install the machine on a flat hard floor. Make sure that air circulation around the machine is not impeded by carpets, rugs etc. Check that the machine does not touch the wall or other kitchen units. Level the washing machine by raising or lowering the feet. The feet may be tight to adjust as they incorporate a self locking nut, but the machine **MUST** be level and stable.

Any necessary adjustment can be made with a spanner. Accurate levelling prevents vibration, noise and displacement of the machine during operation. Never place cardboard, wood or similar materials under the machine to compensate for any unevenness in the floor.

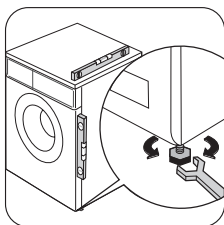

If necessary, check the setting with a spirit level.

## Water inlet

**Warning!** This appliance must be connected to a cold water supply

**Caution!** Before connecting up the appliance to new pipework or to pipework that has not been used for some time, run off a reasonable amount of water to flush out any debris that may have collected

**Caution!** Do not use the hose from your previous appliance to connect to water supply.

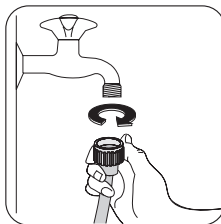

Connect the hose to a tap with a 3/4" thread. Always use the hose supplied with the appliance.

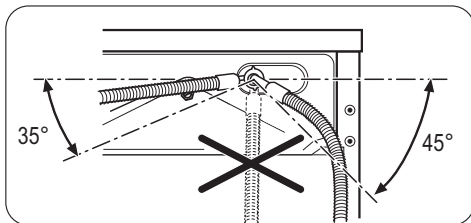

The other end of the inlet hose which connects to the appliance can be turned as showed in the picture.

**Do not place the inlet hose downwards.** Angle the hose to the left or right depending on the position of your water tap. Set the hose correctly by loosening the ring nut. After positioning the inlet hose, be sure to tighten the ring nut again to prevent leaks.

**Caution!** The inlet hose must not be lengthened. If it is too short and you do not wish to move the tap, you will have to purchase a new, longer hose specially designed for this type of use.

## Water drainage

The end of the drain hose can be positioned in three ways:

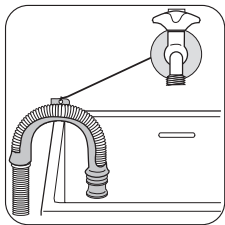

**Hooked over the edge of a sink using the plastic hose guide supplied with the machine.**

In this case, make sure the end cannot come unhooked when the machine is emptying. This could be done by tying it to the tap with a piece of string or attaching it to the wall.

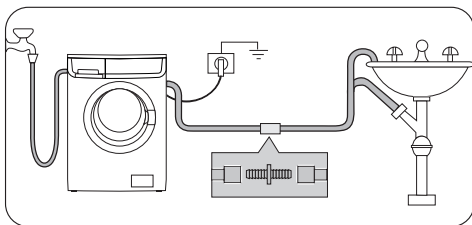

**In a sink drain pipe branch** . This branch must be above the trap so that the bend is at least 60 cm above the ground.

**Directly into a drain pipe at a height** of not less than 60 cm and not more than 90 cm. The end of the drain hose must always be **ventilated** , i.e. the inside diameter of the drain pipe must be larger than the outside diameter of the drain hose. The drain hose must not be kinked.

## Electrical connection

Information on the electrical connection is given on the rating plate on the inner edge of the appliance door.

Check that your domestic electrical installation can take the maximum load required, also taking into account any other appliances in use.

**!** **Caution!** Connect the machine to an earthed socket.

**!** **Warning!** The appliance is supplied with a 13amp plug fitted. In the event of having to change the fuse in the plug supplied, a 13amp ASTA approved (BS1363/A) fuse must be used.

**!** **Caution!** The manufacturer does not accept any responsibility for damage or injury through failure to comply with the above safety precaution.

**!** **Caution!** Should the appliance power supply cable need to be replaced, this **MUST** be carried out by a Service Centre.

**i** **The power supply cable must be easily accessible after installing the machine.**

## Environment concerns

The symbol  on the product or on its packaging indicates that this product may not be treated as household waste. Instead it should be taken to the appropriate collection point for the recycling of electrical and electronic equipment. By ensuring this product is disposed of correctly, you will help prevent potential negative consequences for the environment and human health, which could otherwise be caused by inappropriate waste handling of this product. For more detailed

information about recycling of this product, please contact your local council, your household waste disposal service or the shop where you purchased the product.

### Packaging materials

The materials marked with the symbol  are recyclable.

>PE<=polyethylene

>PS<=polystyrene

>PP<=polypropylene

This means that they can be recycled by disposing of them properly in appropriate collection containers.

### **Ecological hints**

To save water, energy and to help protect the environment, we recommend that you follow these tips:

- Normally soiled laundry may be washed without pre-washing in order to save detergent, water and time (the environment is protected too!).
- The machine works more economically if it is fully loaded.
- With adequate pre-treatment, stains and limited soiling can be removed; the laundry can then be washed at a lower temperature.
- Measure out detergent according to the water hardness, the degree of soiling and the quantity of laundry being washed.



